

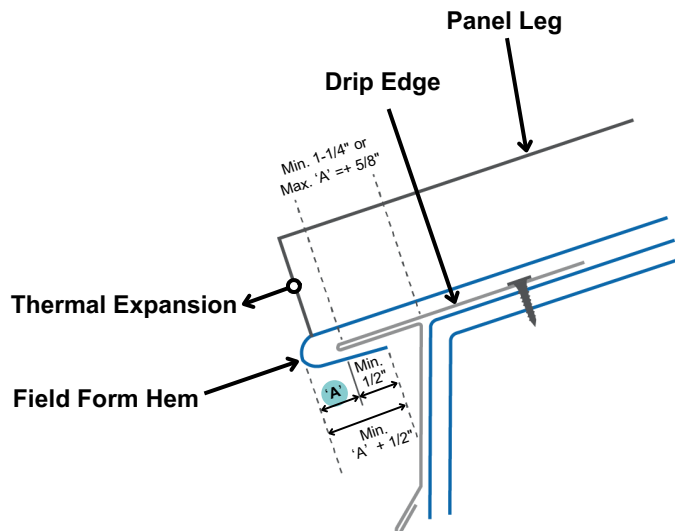

Setting Panel Thermal Gap During Installation



Refer to Table 1 for gap.

NOTE

'A' = Gap from Thermal Expansion Chart during time of installation

Panel Hemming

- 1 Notch vertical legs back from eave end of panel equal to hem length (nominally 1 inch or maximum dimension provided.)

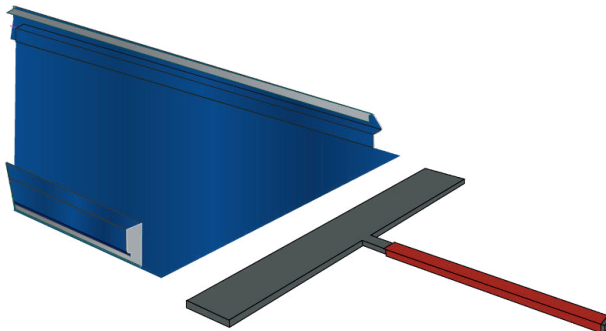

- 2 Use panel hemming tool to fold panel end 180 degrees.

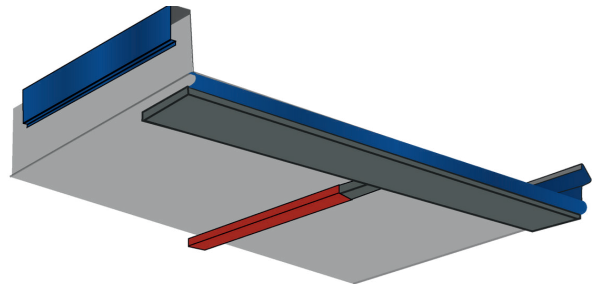

Closing Female Rib End (optional)

- 1 Leave 1" tab along inside of female leg after hemming panel and.

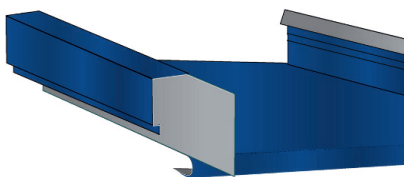

- 2 Fold tab around end of rib to close off opening.

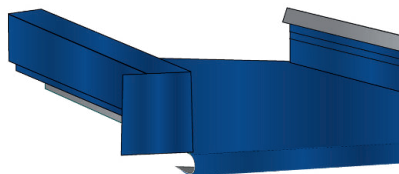

- 3 Snip off excess tab along outside profile of rib.

