

**DYNAMIC CLASS 1150 0.032" ALUMINUM  
1" MECHANICAL SEAM x 13", 17", or 21" WIDE ROOF PANEL  
OVER 1/2" PLYWOOD**

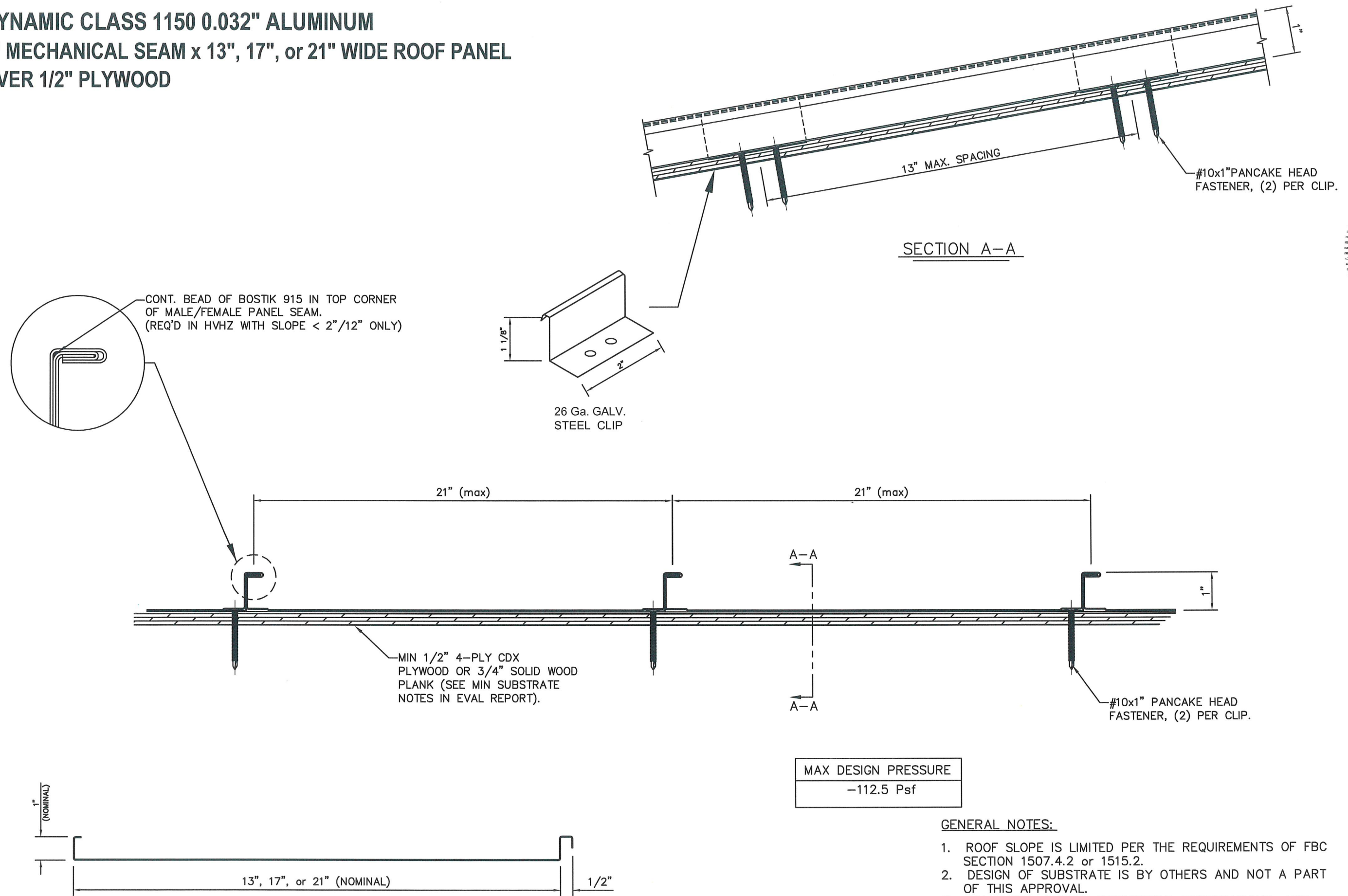

CONT. BEAD OF BOSTIK 915 IN TOP CORNER OF MALE/FEMALE PANEL SEAM. (REQ'D IN HVHZ WITH SLOPE < 2"/12" ONLY)

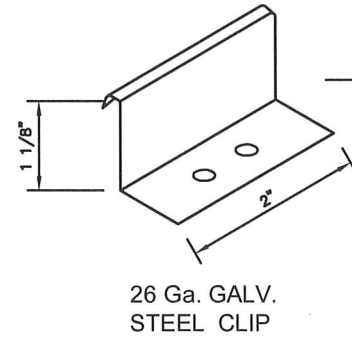

MIN 1/2" 4-PLY CDX PLYWOOD OR 3/4" SOLID WOOD PLANK (SEE MIN SUBSTRATE NOTES IN EVAL REPORT).

MAX DESIGN PRESSURE  
-112.5 Psf

**GENERAL NOTES:**

1. ROOF SLOPE IS LIMITED PER THE REQUIREMENTS OF FBC SECTION 1507.4.2 or 1515.2.
2. DESIGN OF SUBSTRATE IS BY OTHERS AND NOT A PART OF THIS APPROVAL.
3. ALL PANEL SYSTEM PERIMETERS, PENETRATIONS, AND TRANSITIONS TO BE FLASHED AND SEALED PER THE REQUIREMENTS OF RAS 133.
4. THE 0.032" THICKNESS LISTED IS MINIMUM. THICKER PANELS ARE ALSO APPROVED.

DATE	10/14/22
REV.#	1
DESCRIPTION	1/24/24
1ST SUBMITTAL	10/14/22
2ND SUBMITTAL	
3RD SUBMITTAL	
4TH SUBMITTAL	
5TH SUBMITTAL	
6TH SUBMITTAL	
7TH SUBMITTAL	
8TH SUBMITTAL	
9TH SUBMITTAL	
10TH SUBMITTAL	

SCOTT WOLTERS  
FL PE# 62354  
WOLTERS ENGINEERING  
(COA# 27194)  
15211 97TH ROAD N  
WEST PALM BEACH, FL 33412  
(561) 225-1982

**DYNAMIC METALS**  
2951 SE DOMINICA TERRACE  
STUART, FL 34997  
2177 ANDREWS LANE  
FT. MYERS, FL 33912  
www.dynamicmetal.net  
PH: (772) 247-2465  
FAX: (772) 247-2466  
PH: (239) 265-1638  
EMAIL: info@dynamicmetal.net

